

KEY

- **PROPOSED NO WAITING AT ANY TIME**
- x-x-x- **PROPOSED NO WAITING MONDAY - FRIDAY 10.00 - 11.00**
- **EXISTING WAITING AND PARKING RESTRICTIONS**

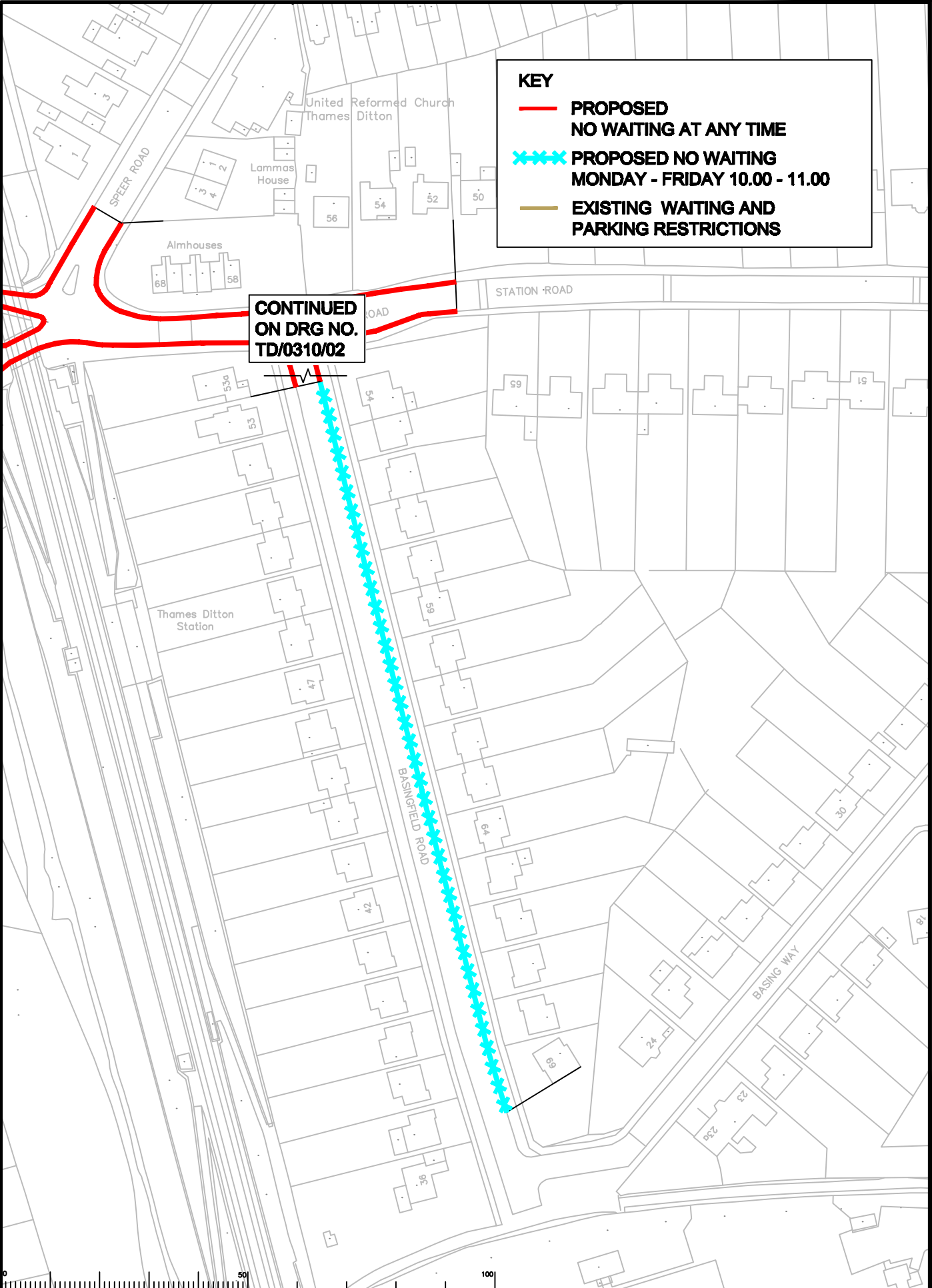

**CONTINUED
ON DRG NO.
TD/0310/02**

Rev	Description	Drwn	Slg.	Date	Chkd	Slg.	Date	Appr	Slg.	Date

North Point

Scale: 1:1250

Drawn by: CAH, Date: 01/10
 Checked by: JP, Date: 01/10
 Approved by: RH, Date: 01/10

Project: THAMES DITTON, ELMBRIDGE PARKING REVIEW
 2010 PROPOSED RESTRICTIONS
 Basingfield Road

Project No. 3282/ELM
 Contract Sheet No. TD/0310/03
 Drawing No. -
 Date of Issue: PRESENTATION

SURREY COUNTY COUNCIL
 Sustainable Development
 Surrey Highways